

**Inch**

Screw Size	Part Number	A/F inch/mm	L inch/mm	OD inch/mm
2	HWI-2	.120/3.05	.040/1.02	.445/11.30
3	HWI-3	.182/4.62	.044/1.12	.445/11.30
4	HWI-4	.182/4.62	.049/1.24	.445/11.30
5	HWI-5	.182/4.62	.058/1.47	.445/11.30
6	HWI-6	.245/6.22	.067/1.70	.445/11.30
6	HWI-6-1	.245/6.22	.080/2.03	.445/11.30
6	HWI-6-2	.245/6.22	.067/1.70	.671/17.04
6	HWI-6-3	.245/6.22	.080/2.03	.671/17.04
7	HWI-7	.245/6.22	.080/2.03	.671/17.04
8	HWI-8	.245/6.22	.096/2.44	.671/17.04
10	HWI-10	.306/7.77	.106/2.69	.671/17.04
12	HWI-12	.306/7.77	.139/3.53	.671/17.04
14 & 1/4	HWI-14	.368/9.35	.172/4.37	.671/17.04
14 & 1/4	HWI-14-1	.430/10.92	.172/4.37	.671/17.04
14 & 1/4	HWI-14-2	.430/10.92	.172/4.37	.875/22.23
14 & 1/4	HWI-14-3	.368/9.35	.172/4.37	.875/22.23
5/16	HWI-31	.490/12.45	.207/5.26	.875/22.23
3/8	HWI-37	.554/14.07	.270/6.86	.875/22.23

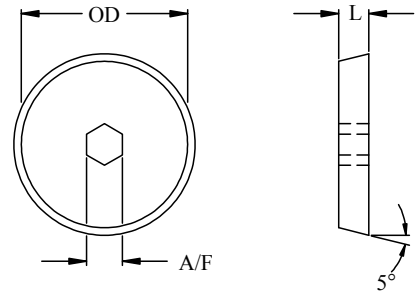

**Metric (IFI 502 & 513)**

Screw Size	Part Number	A/F inch/mm	L inch/mm	OD inch/mm
3.2	HWM-3.2	.120/3.05	.040/1.02	.445/11.30
4	HWM-4	.151/3.84	.044/1.12	.445/11.30
5	HWM-5	.191/4.85	.050/1.27	.445/11.30
5.5	HWM-5.5	.211/5.36	.080/2.03	.445/11.30
7	HWM-7	.270/6.86	.096/2.44	.671/17.04
8	HWM-8	.308/7.82	.105/2.67	.671/17.04
8	HWM-8-1	.308/7.82	.139/3.53	.671/17.04
10	HWM-10	.387/9.83	.172/4.37	.875/22.23
13	HWM-13	.503/12.78	.208/5.28	.875/22.23

**Metric (DIN 558)**

Screw Size	Part Number	A/F inch/mm	L inch/mm	OD inch/mm
4	HWM-4-558	.267/6.78	.100/2.54	.671/17.04
5	HWM-5-558	.303/7.70	.128/3.25	.671/17.04
6	HWM-6-558	.383/9.73	.147/3.73	.671/17.04
8	HWM-8-558	.502/12.75	.206/5.23	.875/22.23
10	HWM-10-558	.658/16.71	.265/6.73	1.125/28.58
12	HWM-12-558	.749/19.02	.305/7.75	1.250/31.75

1. M-2 Material at 58-60RC.
2. Special materials available upon request.
3. PVD coatings available.